

VEHICLE SWEEP PATH ANALYSIS - CAR ENTRY FROM MOSS STREET

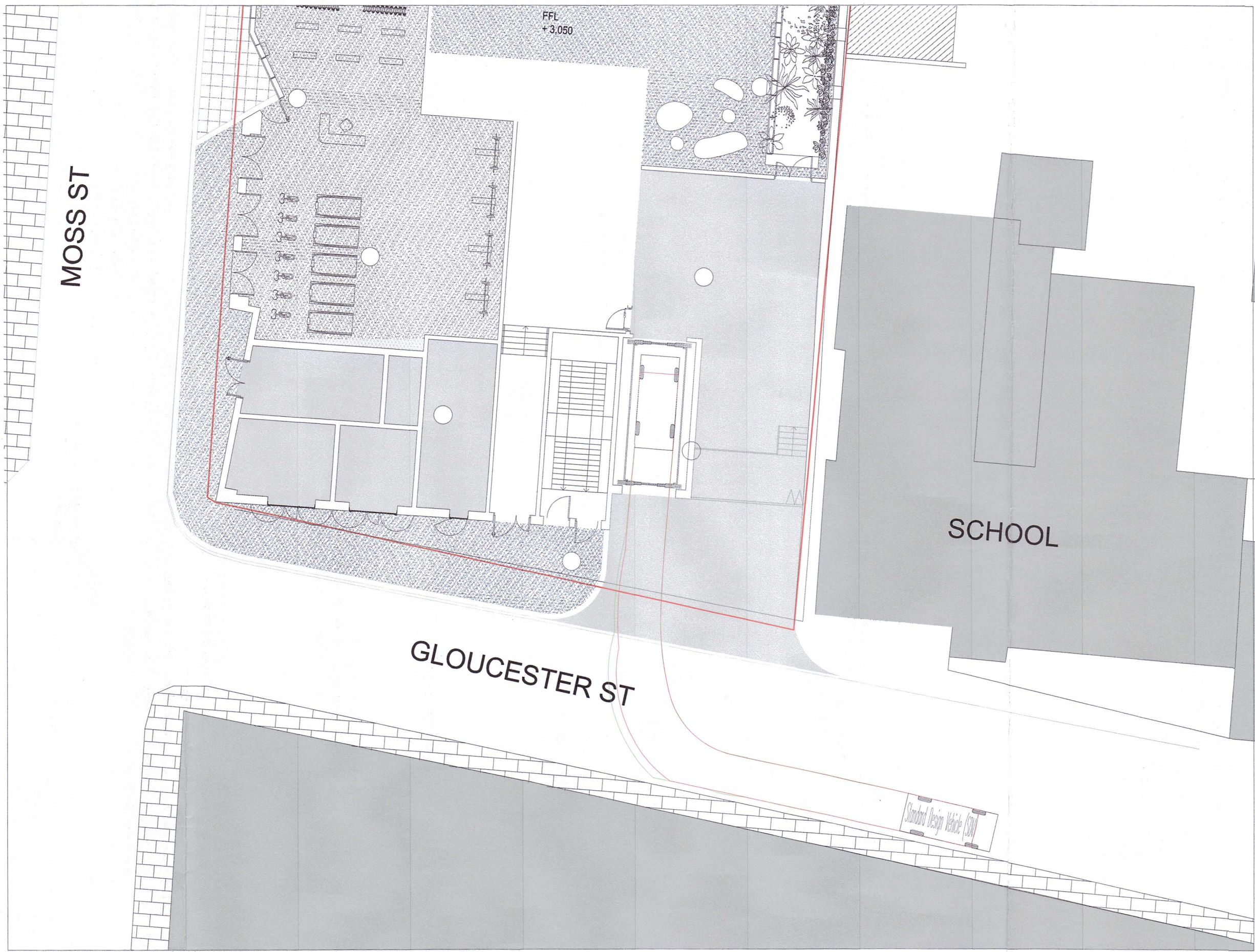

VEHICLE SWEEP PATH ANALYSIS - CAR ENTRY FROM GLOUCESTER STREET

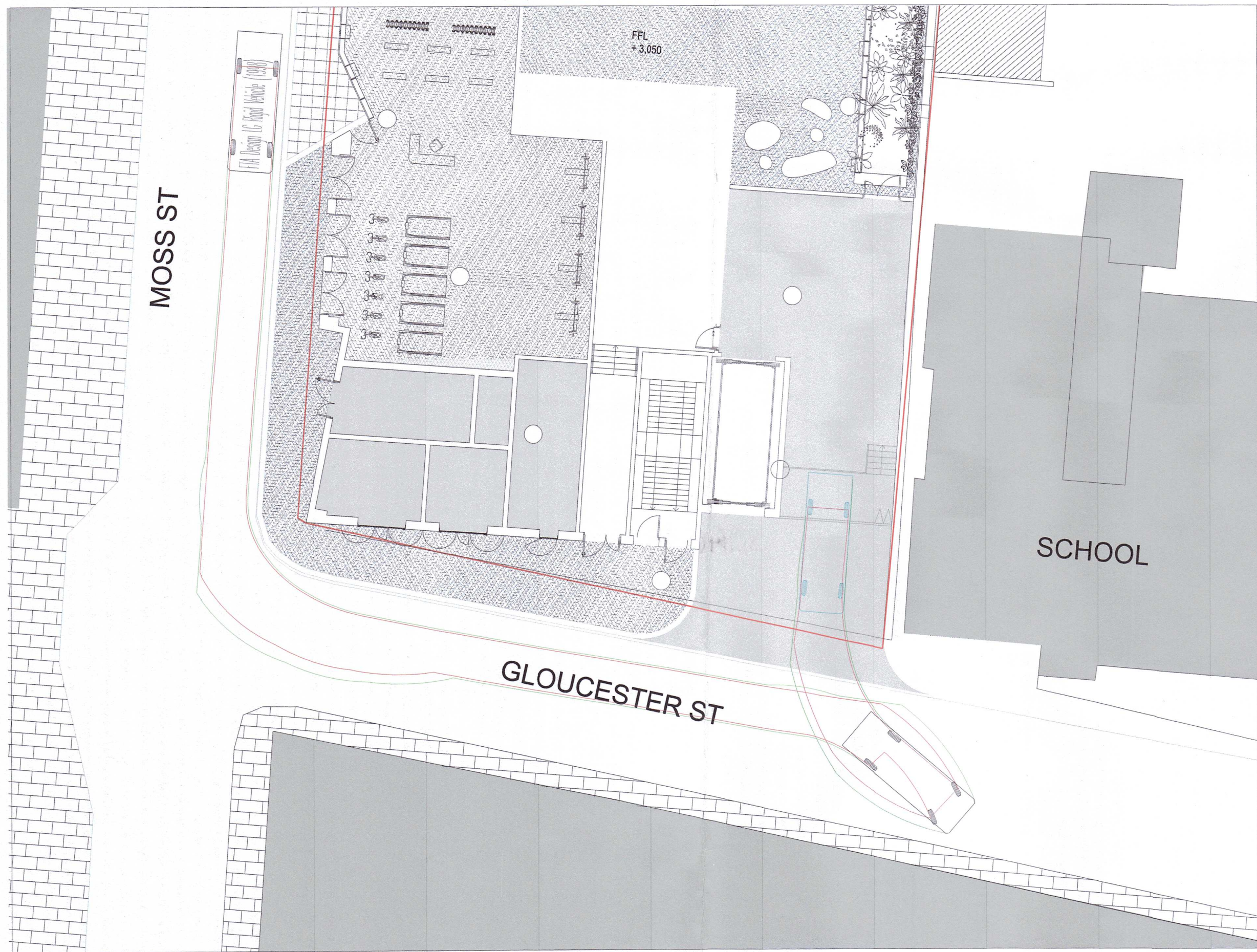

VEHICLE SWEEP PATH ANALYSIS -  
LIGHT GOODS VEHICLE ENTRY REVERSING MOVEMENT (FROM MOSS STREET)

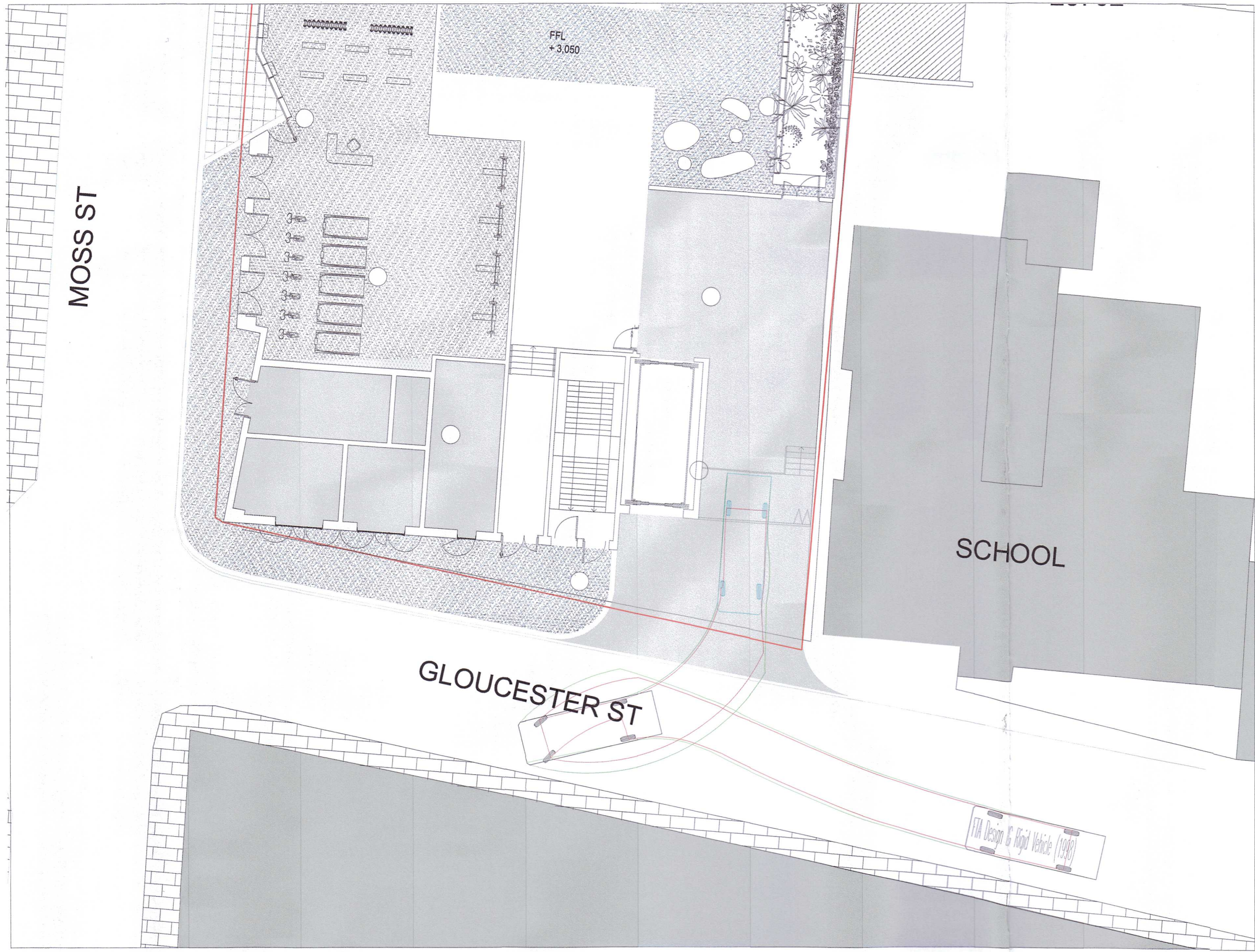

VEHICLE SWEEP PATH ANALYSIS -  
LIGHT GOODS VEHICLE ENTRY REVERSING MOVEMENT (FROM GLOUCESTER STREET)

GENERAL NOTES

1. DO NOT SCALE OFF DRAWING.
2. ALL DIMENSIONS TO BE CONFIRMED ON SITE.
3. EXISTING SERVICES/UTILITIES SHALL BE THE RESPONSIBILITY OF THE CONTRACTOR TO DETERMINE AND VERIFY THE EXACT HORIZONTAL AND VERTICAL ALIGNMENT OF ALL CABLES, PIPE ETC. (BOTH UNDERGROUND AND OVERHEAD) PRIOR TO THE COMMENCEMENT OF THE WORKS.

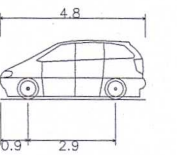
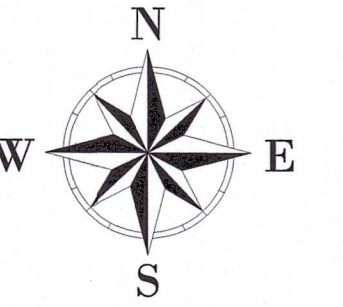

Standard Design Vehicle (SDV)	
Overall Length	4.800m
Overall Width	2.000m
Overall Body Height	1.950m
Min. Body Ground Clearance	0.100m
Track Width	2.000m
Lock to Lock Time	2.00s
Wall to Wall Turning Radius	6.000m

AN BORD PLEANÁLA

07 NOV 2022

LTR DATED FROM *appellan*

LDG- *22* 315053

ABP- *22* 315053

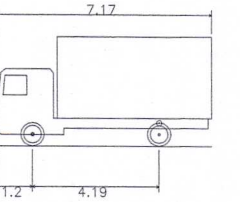

FTA Design LG Rigid Vehicle (1995)	
Overall Length	7.170m
Overall Width	2.300m
Overall Body Height	3.280m
Min. Body Ground Clearance	0.120m
Track Width	2.300m
Lock to Lock Time	3.00s
Kerb to Kerb Turning Radius	7.000m

03	06.07.22	VEHICLE PATHS UPDATED	DM	GMC	MR
02	26.05.22	VEHICLE PATHS UPDATED	DM	GMC	MR
01	29.04.22	UPDATED ARCHITECTS LAYOUT	MG	GMC	MR
00	26.01.22	PRELIMINARY ISSUE	MG	GMC	MR
Rev	Date	Description	By	Chk	App

**BYRNE LOOBY**

WWW.BYRNELOOBY.COM

IRELAND | UK | UAE | BAHRAIN | KSA

CLIENT  
BAKKALA CONSULTING  
ENGINEERS

PROJECT  
CITY QUAY

DRAWING TITLE  
VEHICLE SWEEP PATH ANALYSIS  
STREET LEVEL  
CAR & LIGHT GOODS VEHICLE

STATUS  
PLANNING

Date: 26.01.2022	Scale: 1:200	Drawn: MG	Chk: GMC	App: MR
Project No: B1876	Drg. No: B1876-XX-XX-C-SK-0004	Rev: 03		